

Chassis Brackets

Front end cylinder chassis brackets

Note : Please verify quoted dimensions with your local Hyva subsidiary or agent prior to use

Chassis bracket for cylinder type: FC/FE 110/118/129/137/149

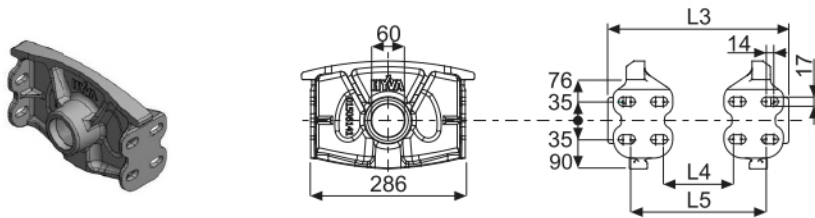

Cylinder type	L3 (mm)	L4 (mm)	L5 (mm)
FC/FE 110	307	103	223
FC/FE 118	324	120	240
FC/FE 129	345	141	261
FC/FE 137	345	141	261
FC/FE 149	345	141	261

Bracket Type	Part no. Bracket	Mass (Kg)	Part no. Replacement bush
Maintenance free	015 06 141	7.5	017 94 240
Greased version	015 06 146	7.7	017 94 020

Chassis bracket for cylinder type FC/FE 137/149

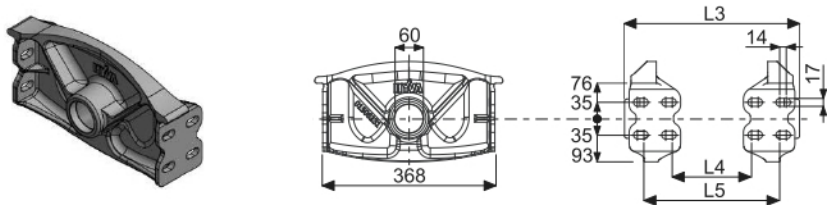

Cylinder type	L3 (mm)	L4 (mm)	L5 (mm)
FC/FE 137	345	141	261
FC/FE 149	345	141	261

Bracket Type	Part no. Bracket	Mass (Kg)	Part no. Replacement bush
Maintenance free	015 06 131	11	017 94 240
Greased version	015 06 136	11.2	017 94 020

Chassis bracket for cylinder type FC/FE 157/169/179/191

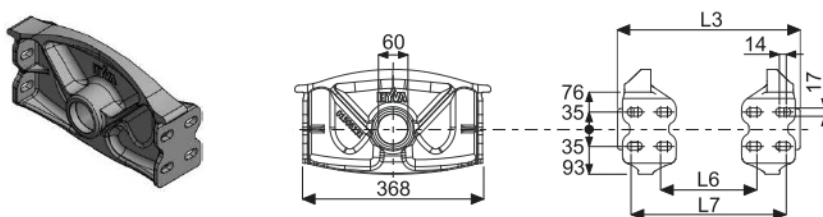

Cylinder type	L3 (mm)	L6 (mm)	L7 (mm)
FC/FE 157	387	211	331
FC/FE 169	387	211	331
FC/FE 179	387	211	331
FC/FE 191	387	211	331

Bracket Type	Part no. Bracket	Mass (Kg)	Part no. Replacement bush
Maintenance free	015 06 131	11	017 94 240
Greased version	015 06 136	11.2	017 94 020

Chassis bracket for cylinder type FC/FE 214

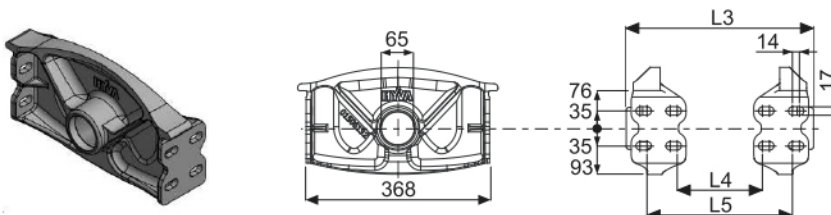

Cylinder type	L3 (mm)	L4 (mm)	L5 (mm)
FC/FE 214	412	211	331

Bracket Type	Part no. Bracket	Mass (Kg)	Part no. Replacement bush
Maintenance free	015 06 132	10.8	017 94 210
Greased version	015 06 133	11	017 94 025

General information

For all chassis brackets use:

- Bolts M16x1.5 Property Class 8.8 or higher.
- Self-locking nuts M16 Property Class 8 or higher.
- Washer 17x30 over slotted holes in the bracket.

Bolts kits are available:

- Q005: 16 bolts M16x50, nuts and washers for chassis brackets (2.3 kg).

Note:

- Brackets are painted black (RAL 9005 / gloss 25%).
- Weight can vary as per casting process.
- Greased versions includes M8x1 grease nipple.
- For mounting, see instructions CYL-0030 or CYL-0031.
- For bush replacement, see instruction BRA-0002.

Cylinder load Specifications

Part no. Bracket	Max. Cylinder Load (kN)
015 06 131 / 141	235
015 06 132	255
015 06 146	290
015 06 133 / 136	440

Този продукт се предлага от:



Гр. София, ул. Чelopeшко шосе 10-12
0886 441 442 / 0898 447 449
www.hydraulicstore.eu

HYDRAULIC PARTS & EQUIPMENT